

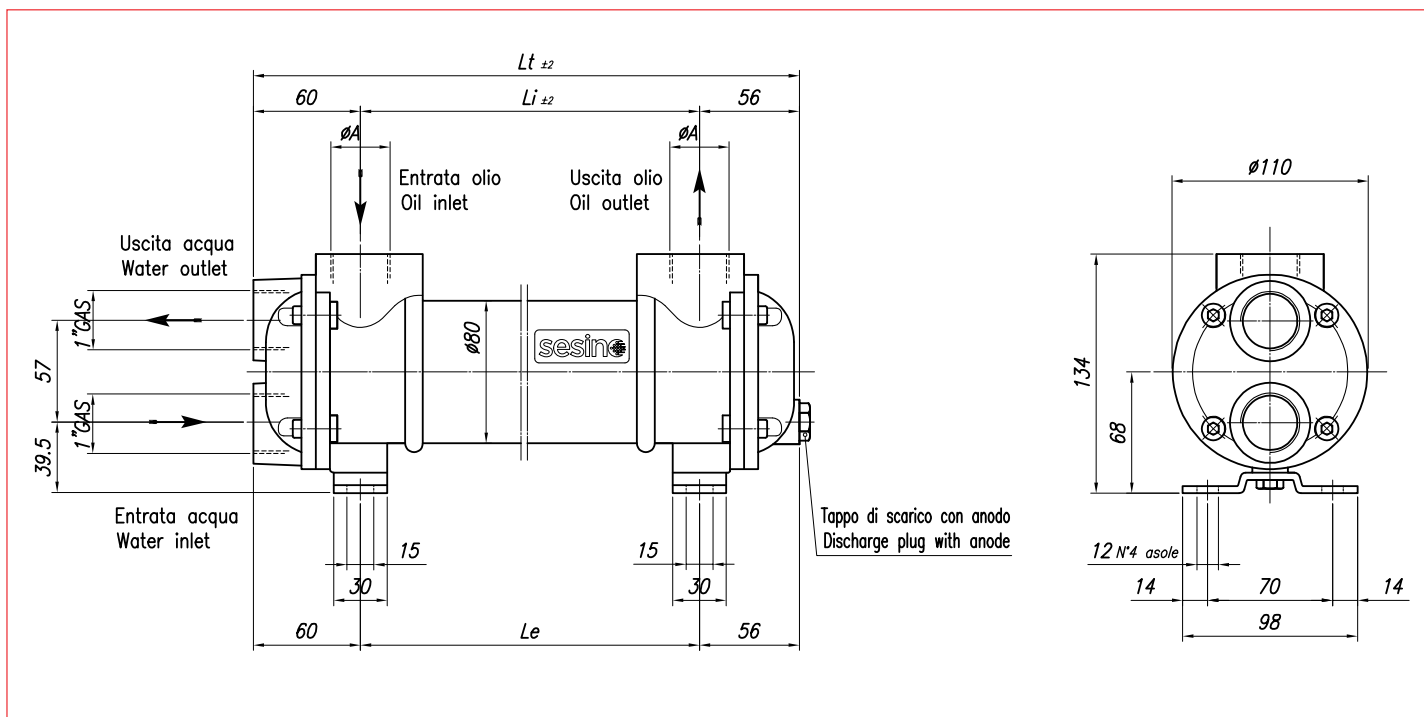

| CONSTRUCTION MATERIALS | | |
|------------------------|-------------------|-----------------|
| SHELL | TUBES | END COVERS |
| BRASS | CuNi (marine use) | BRONZE |
| CARBON STEEL | COPPER | CAST IRON |
| STAINLESS STEEL | STAINLESS STEEL | STAINLESS STEEL |

- Dimensions and technical characteristics are not binding

*standard



| TYPE | CODE | OIL FLOW l/min | WATER FLOW l/min | kW MIN water flow | | kW MAX water flow | | WEIGHT kg | DIMENSIONS | | | |
|------------|--------------|-------------------|---------------------|-------------------|-------------------|-------------------|-------------------|--------------|------------|-----|-----|------|
| | | | | ΔTm 25° C | ΔTm 25° C | ΔTm 25° C | ΔTm 25° C | | ϕA | Li | Le | Lt |
| MS 84/2 B1 | 2SC84/2B1CNA | 30-80 | 7,5 - 30 | 2 | 3 | 2,6 | 4,2 | 4,5 | 1" gas | 150 | 150 | 266 |
| MS 84/2 B2 | 2SC84/2B2CNA | 20-60 | 7,5 - 30 | 2,6 | 4 | 3,25 | 5,6 | 6,3 | 1" gas | 310 | 310 | 426 |
| MS 84/2 B3 | 2SC84/2B3CNA | 50-100 | 7,5 - 30 | 3,6 | 4,4 | 4,6 | 8 | 6,5 | 1 1/2" gas | 310 | 325 | 441 |
| MS 84/2 B4 | 2SC84/2B4CNA | 30-80 | 7,5 - 30 | 4,8 | 7 | 6 | 10 | 9,0 | 1" gas | 560 | 560 | 676 |
| MS 84/2 B5 | 2SC84/2B5CNA | 80-130 | 7,5 - 30 | 6 | 7 | 7 | 9 | 9,0 | 1 1/2" gas | 560 | 575 | 691 |
| MS 84/2 B6 | 2SC84/2B6CNA | 40-90 | 7,5 - 30 | 9 | 12 | 12 | 18 | 10,8 | 1 1/2" gas | 715 | 730 | 846 |
| MS 84/2 B7 | 2SC84/2B7CNA | 100-160 | 7,5 - 30 | 11 | 14 | 15 | 21 | 10,8 | 1 1/2" gas | 715 | 730 | 846 |
| MS 84/2 B8 | 2SC84/2B8CNA | 60-110 | 7,5 - 30 | 12 | 16 | 16 | 24 | 12,3 | 1 1/2" gas | 870 | 885 | 1001 |
| MS 84/2 B9 | 2SC84/2B9CNA | 140-190 | 7,5 - 30 | 15 | 17 | 21 | 27 | 12,3 | 1 1/2" gas | 870 | 885 | 1001 |



WATER FLOW RATE:



B1 B2 B3

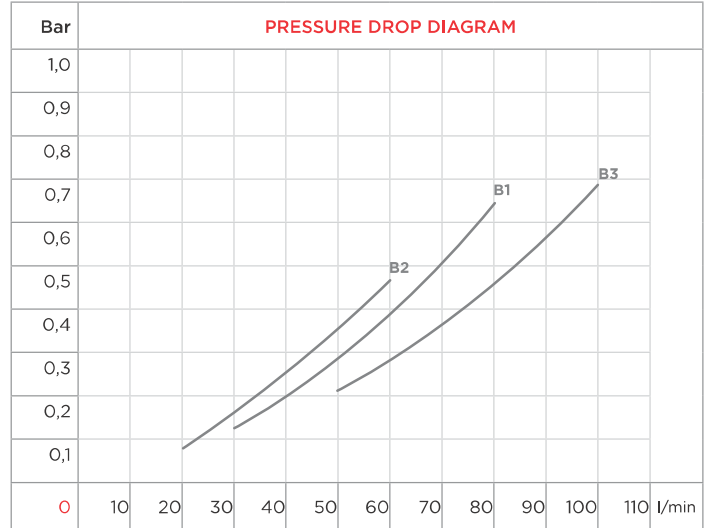
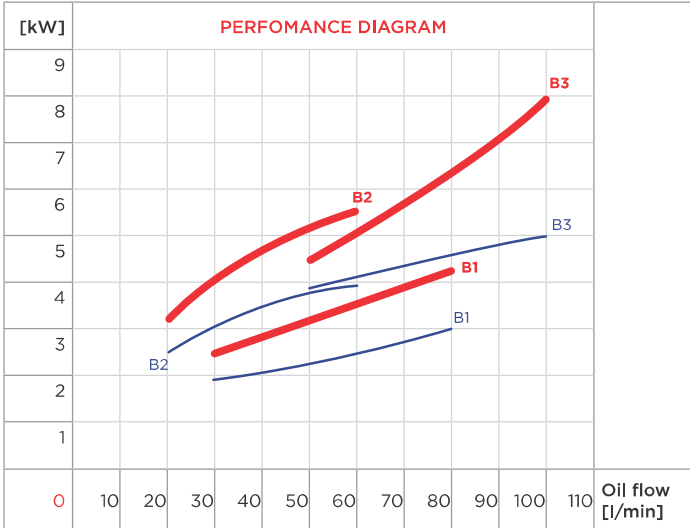

B4 B5 B6

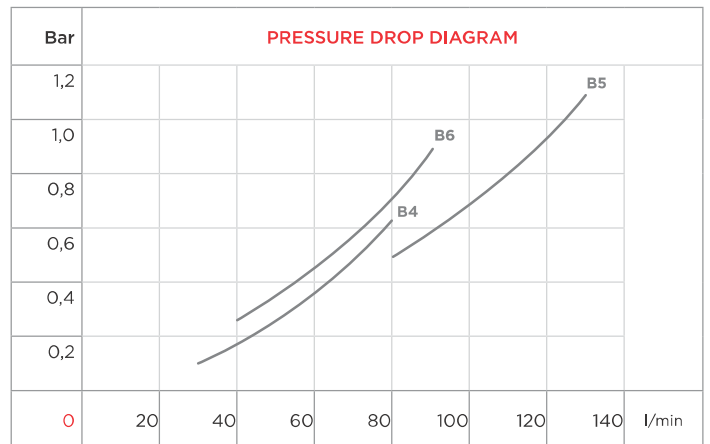

B7 B8 B9

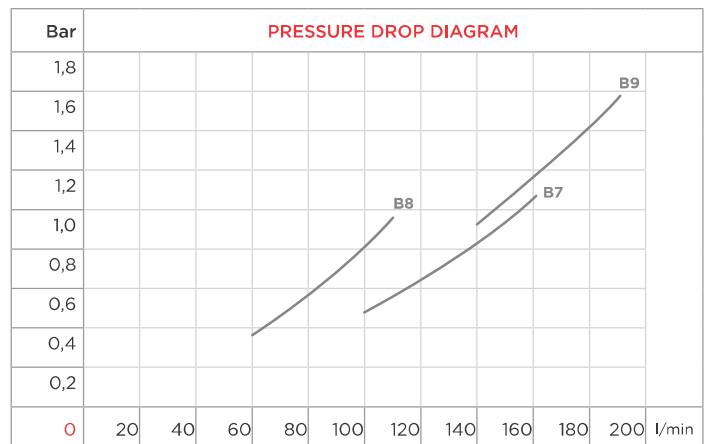
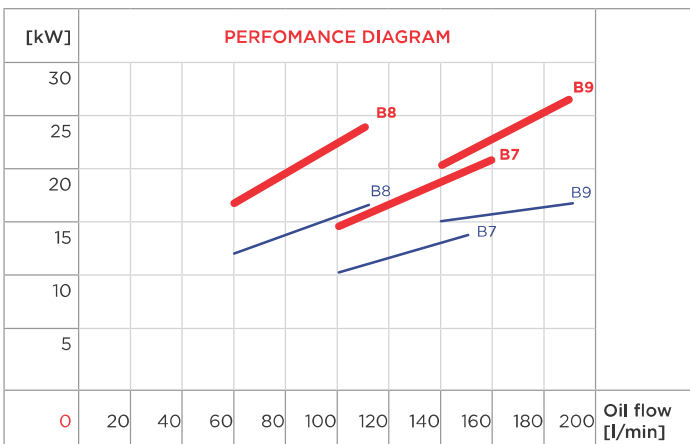

| CORRECTION FACTOR | | | | | | | |
|-------------------|-----|------|------|----|------|------|------|
| ΔT_m | 10 | 15 | 20 | 25 | 30 | 35 | 40 |
| f | 2,5 | 1,67 | 1,25 | 1 | 0,83 | 0,71 | 0,63 |

| CORRECTION FACTOR | | | | | | | |
|-------------------|-----|-----|----|-----|-----|-----|-----|
| cSt | 22 | 30 | 46 | 68 | 100 | 150 | 220 |
| f | 0,4 | 0,6 | 1 | 1,5 | 2,3 | 3,3 | 4,6 |